

767 Third Avenue

TYPICAL FLOORS 7 - 17 | 7,537 RSF | CORE & SHELL PLAN

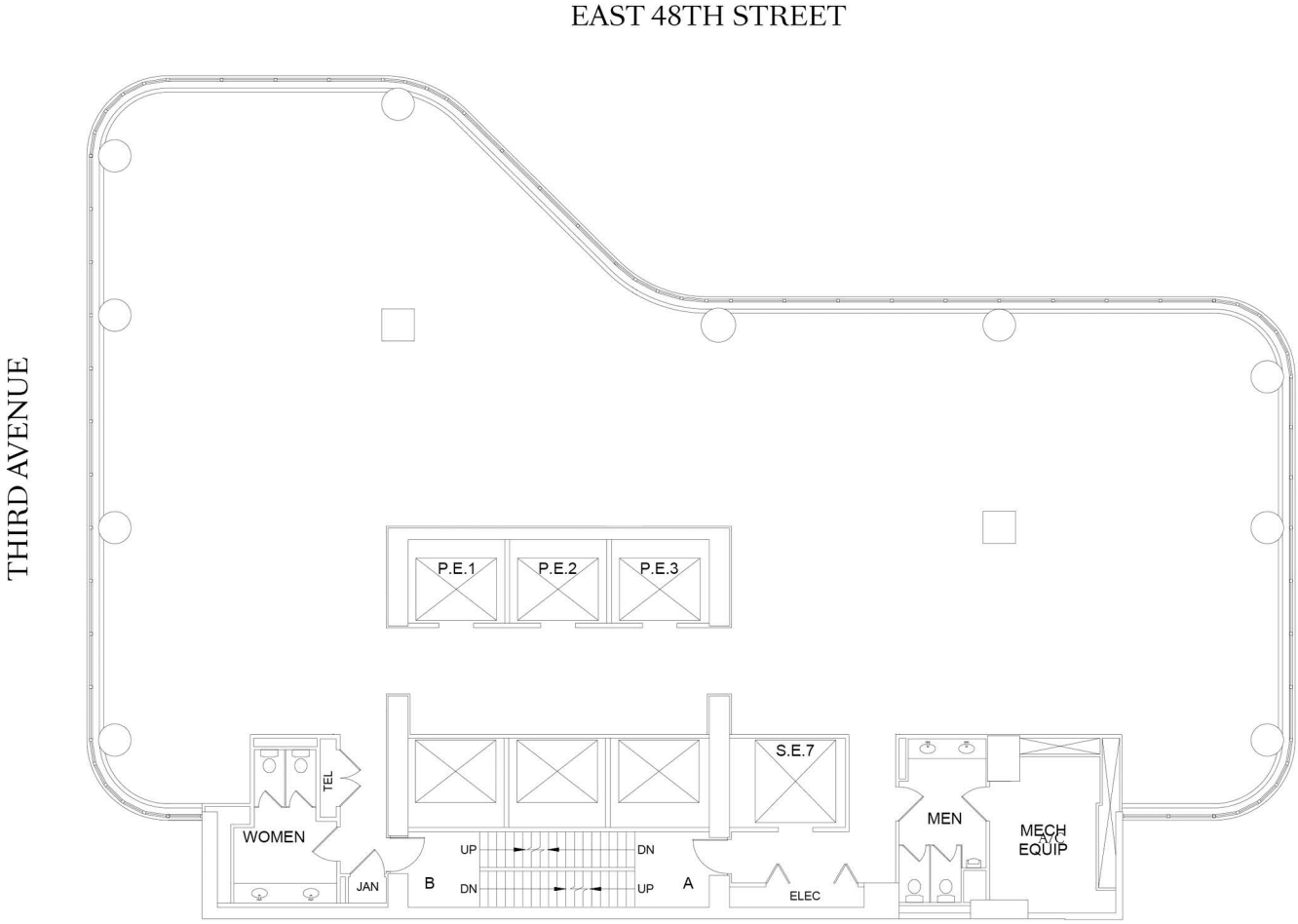

767 Third Avenue

TYPICAL FLOORS 7 - 17 | 7,537 RSF | OFFICE INTENSIVE TESTFIT PLAN

#	TYPE
13	OFFICES
7	WORKSTATIONS
1	CONFERENCE ROOM
1	MEETING ROOM
1	PHONE ROOM
1	WELLNESS ROOM
20	TOTAL



767thirdave.com

Michael I. Lenchner
Executive Vice President & Director of Leasing
T. 212 758-0437
mленchner@sagerealty.com

sagespace.com



767 Third Avenue

TYPICAL FLOORS 7 - 17 | 7,537 RSF | OPEN LAYOUT TESTFIT PLAN

#	TYPE
7	OFFICES
21	WORKSTATIONS
1	CONFERENCE ROOM
1	MEETING ROOM
1	PHONE ROOM
1	WELLNESS ROOM
28	TOTAL



767thirdave.com

Michael I. Lenchner
Executive Vice President & Director of Leasing
T. 212 758-0437
[mlenchner@sagerealty.com](mailto:mленchner@sagerealty.com)

sagespace.com

